

5/32 RUTLEDGE STREET KILMORE, VIC



3



2



1

KILMORE UNIT FOR SALE

New Townhouse for sale...

The opportunity awaits to secure a three bedroom townhouse adjacent to the world renowned Kilmore International School right in the heart of Kilmore, completed to the highest standard with stainless steel brand-name kitchen appliances, integrated security systems, high quality bathroom fixtures and fittings.

The property features both downstairs and upstairs living areas, modern kitchen with island, three large comfortable bedrooms with built in robes, bathrooms on both levels, laundry and a single car remote accessed garage that can be accessed directly from the house. Comfort is addressed with inverter split system air conditioners to living areas and master bedroom, quality carpet to bedrooms and living areas and large format quality tiles to the remainder of the unit for easy cleaning. Outside a private landscaped backyard with established lawn and very low maintenance gardens, concrete and gravel pathways and washing line. The backyard also has direct gated access to the rear reserve. This is such an amazing opportunity to secure the ideal investment or to secure the new family home in such a high!

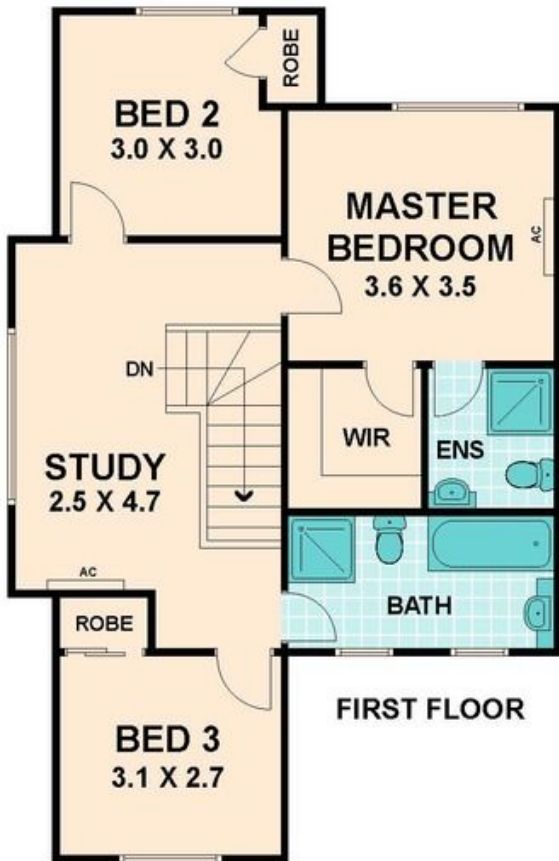

Wilson Partners

5/32 RUTLEDGE STREET

KILMORE, VIC